

**SCHMALES KAPPENSCHLOSS 802**

SELBSTSCHLIESSEND, MIT GERADER GRUNDPLATTE UND GEGENHAKEN

**NARROW TOGGLE 802**

SELF LOCKING, WITH FLAT BASE PLATE AND HOOK

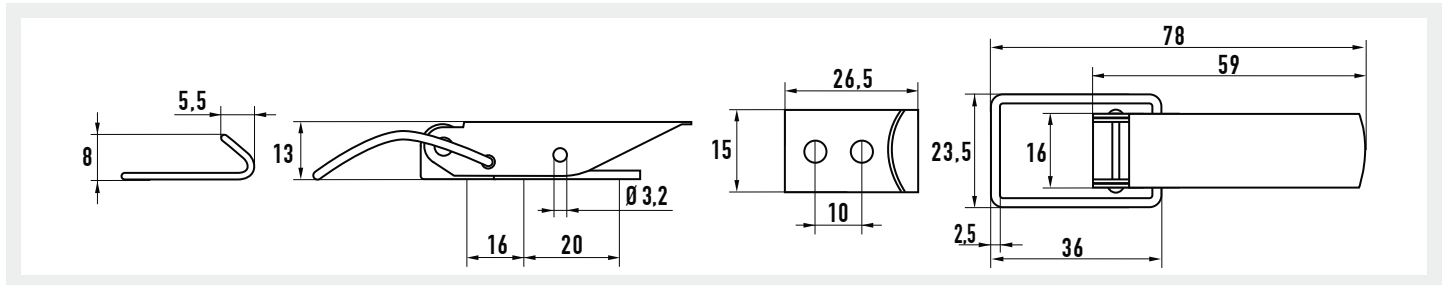

**GRENOUILLÈRE ÉTROITE 802**

AUTOFERMETURE, AVEC PATTE PLATE ET CROCHET





Nietloch / rivet hole / trou pour rivet Ø 3,35 mm / Ø 4,2 mm (Standard)



Stahl verzinkt  
Steel zinc plated  
Acier zingué

Ø		
3,35	100	55430 80201
4,2	100	55430 80200

Edelstahl A2 W.-Nr. 1.4301/03 AISI 304  
Stainless steel A2 W.-Nr. 1.4301/03 AISI 304  
Acier inox A2 W.-Nr. 1.4301/03 AISI 304

Ø		
3,35	100	55445 80201
4,2	100	55445 80200

Aluminium  
Aluminium  
Aluminium

Ø		
3,35	100	55775 80201
4,2	100	55775 80200



Änderungen vorbehalten Subject to modifications Sous réserve de modifications