

## STANDARD KAPPENSCHLOSS 2/55/60 F

MIT FEDERSICHERUNG, GEWÖLBTER GRUNDPLATTE UND GEGENHAKEN

## STANDARD TOGGLE 2/55/60 F

WITH ADDITIONAL SPRING, CURVED BASE PLATE AND HOOK

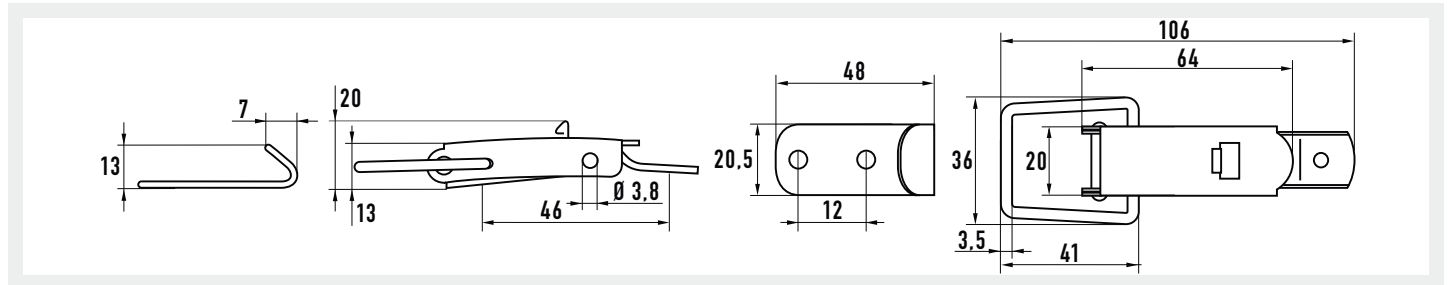

## GRENOUILLÈRE STANDARD 2/55/60 F

AVEC CRAN SÉCURITÉ, PATTE BOMBÉE ET CROCHET





Nietloch / rivet hole / trou pour rivet Ø 3,3 mm / Ø 3,5 mm / Ø 4,2 mm (Standard)



Stahl verzinkt  
Steel zinc plated  
Acier zingué

Ø		
3,3	100	55430 11252
3,5	100	55430 11253
4,2	100	55430 11255

Edelstahl A2 W.-Nr. 1.4301/03 AISI 304  
Stainless steel A2 W.-Nr. 1.4301/03 AISI 304  
Acier inox A2 W.-Nr. 1.4301/03 AISI 304

Ø		
3,3	100	55445 12252
3,5	100	55445 12253
4,2	100	55445 12255

Edelstahl A4 W.-Nr. 1.4401 AISI 316  
Stainless steel A4 W.-Nr. 1.4401 AISI 316  
Acier inox A4 W.-Nr. 1.4401 AISI 316

Ø		
3,3	100	55445 32256
3,5	100	55445 32257
4,2	100	55445 32255

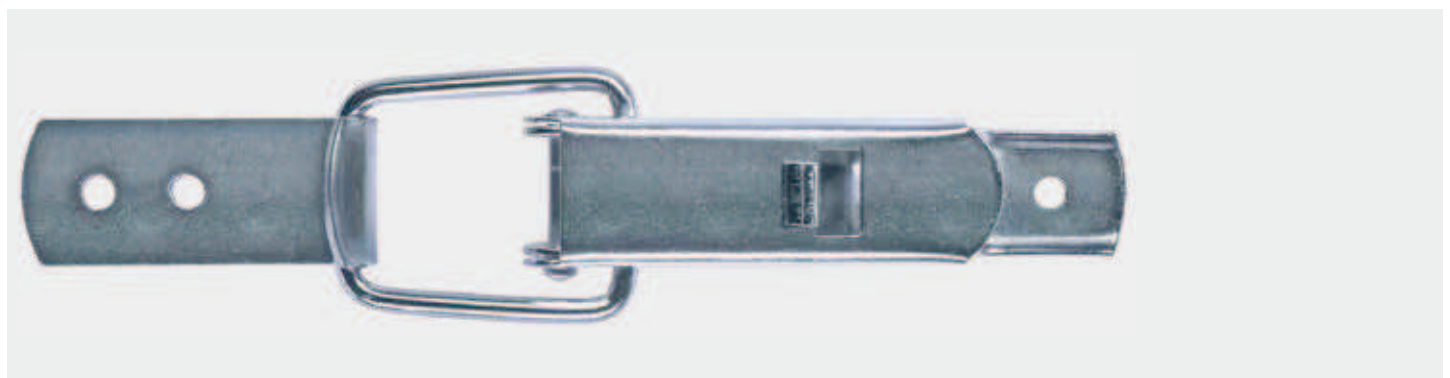

Änderungen vorbehalten Subject to modifications Sous réserve de modifications